 $\Delta L_w = 34 \text{ dB}$

Upcycled polyurethane foam and cellular rubber for rolling noise isolation of floating slabs and screeds.

- ii. Mat dimension: 1.25m x 5m x 25/7mm
- ii. Pallet information: 6 rolls/pallet - pallet: 1200x800x1400mm - 255 kg

MECHANICAL PROPERTIES

MAX. TOTAL LOAD 0.1 MPa	MAX. OCCASIONAL LOAD 1 MPa	DENSITY ⁽¹⁾ 400 kg/m ³	SURFACE WEIGHT ⁽¹⁾ 6.4 kg/m ²
TENSILE STRENGTH ⁽²⁾ > 0.25 MPa	ELONGATION AT BREAK ⁽²⁾ > 50 %	CREEP RATE ⁽³⁾ 0.86 % H/dec	C _{DYN} ⁽⁴⁾ 6 MN/m ³

⁽¹⁾ISO 845 - ⁽²⁾ISO 37 - ⁽³⁾ISO 8013, at 0.02 MPa - ⁽⁴⁾EN 29052-1

THERMAL PROPERTIES

TEMPERATURE RANGE -30°C / 80°C	REACTION TO FIRE Class E ⁽¹⁾ / Class B2 ⁽²⁾	THERMAL CONDUCTIVITY 0.10 W/m°C ⁽³⁾	THERMAL RESISTANCE 0.250 m ² °C/W ⁽³⁾
-----------------------------------	--	---	--

⁽¹⁾EN 13501-1 - ⁽²⁾DIN 4102 - ⁽³⁾EN 12667

ACOUSTICAL RESULTS

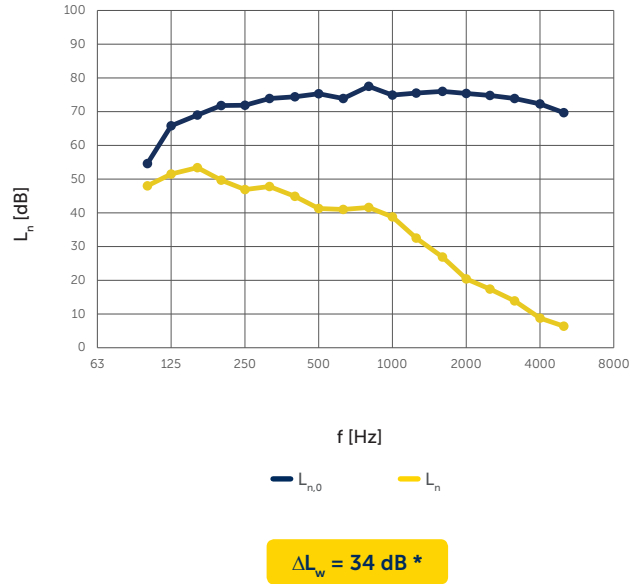
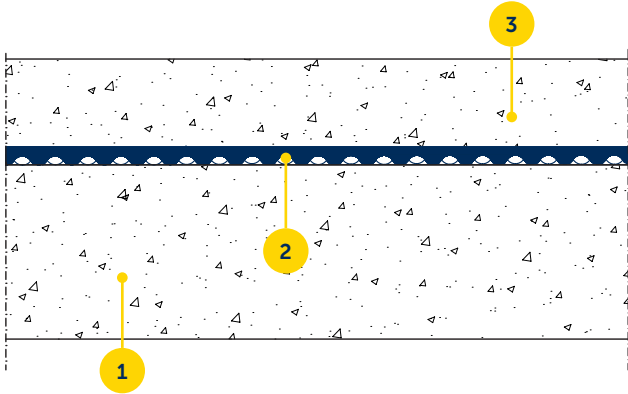

Test setup + test values

1. Standard reinforced concrete floor (140 mm)
2. CDM-MTX-25/7
3. Floating floor: reinforced concrete slab (70 mm)

* Laboratory report available upon request

PHYSICAL & MECHANICAL PROPERTIES

