

$\Delta L_w = 27 \text{ dB}$

Upcycled polyurethane foam and cellular rubber for rolling noise isolation of floating slabs and screeds.

- ii. Mat dimension: 1.25m x 8m x 8/4mm
- ii. Pallet information: 11 rolls/pallet - pallet: 1200x800x1400mm - 280 kg

### MECHANICAL PROPERTIES

MAX. TOTAL LOAD 0.1 MPa	MAX. OCCASIONAL LOAD 1 MPa	DENSITY <sup>(1)</sup> 400 kg/m <sup>3</sup>	SURFACE WEIGHT <sup>(1)</sup> 2.4 kg/m <sup>2</sup>
TENSILE STRENGTH <sup>(2)</sup> > 0.25 MPa	ELONGATION AT BREAK <sup>(2)</sup> > 50 %	CREEP RATE <sup>(3)</sup> 0.77 % H/dec	C <sub>DYN</sub> <sup>(4)</sup> 14 MN/m <sup>3</sup>

<sup>(1)</sup>ISO 845 - <sup>(2)</sup>ISO 37 - <sup>(3)</sup>ISO 8013, at 0.02 MPa - <sup>(4)</sup>EN 29052-1

### THERMAL PROPERTIES

TEMPERATURE RANGE -30°C / 80°C	REACTION TO FIRE Class E <sup>(1)</sup> / Class B2 <sup>(2)</sup>	THERMAL CONDUCTIVITY 0.10 W/m°C <sup>(3)</sup>	THERMAL RESISTANCE 0.080 m <sup>2</sup> C/W <sup>(3)</sup>
-----------------------------------	--	---	---

<sup>(1)</sup>EN 13501-1 - <sup>(2)</sup>DIN 4102 - <sup>(3)</sup>EN 12667

**ACOUSTICAL RESULTS**

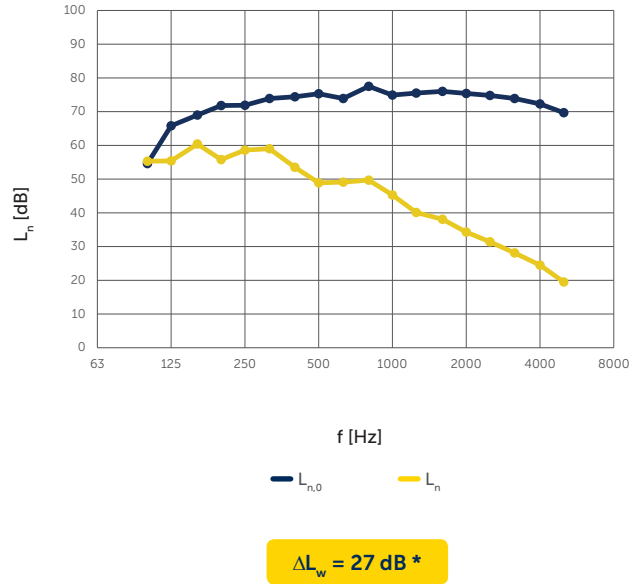
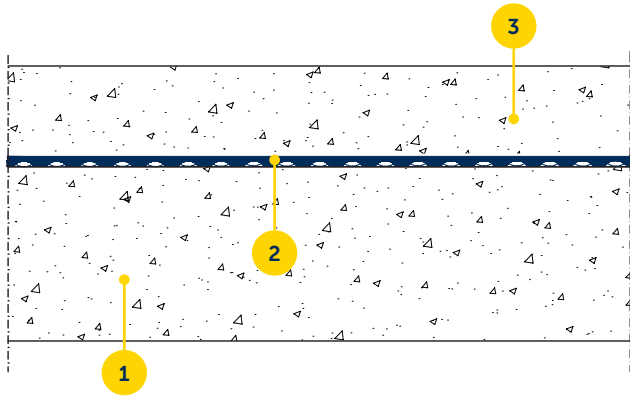

**Test setup + test values**

1. Standard reinforced concrete floor (140 mm)
2. CDM-MTX-8/4
3. Floating floor: reinforced concrete slab (70 mm)

\* Laboratory report available upon request

**PHYSICAL & MECHANICAL PROPERTIES**

