

$\Delta L_w = 27 \text{ dB}$

**100% regenerated crumb rubber for impact noise isolation of floating slabs and screeds.**

- Mat dimension: 1.25m x 10m x 8/4mm
- Pallet information: 8 rolls/pallet - pallet: 1200x800x1400mm - 460 kg

### MECHANICAL PROPERTIES

MAX. TOTAL LOAD 0.10 MPa	MAX. OCCASIONAL LOAD 0.25 MPa	DENSITY <sup>(1)</sup> 710 kg/m <sup>3</sup>	SURFACE WEIGHT <sup>(1)</sup> 4.26 kg/m <sup>2</sup>
TENSILE STRENGTH <sup>(2)</sup> > 0.35 MPa	ELONGATION AT BREAK <sup>(2)</sup> > 40 %	CREEP RATE <sup>(3)</sup> 0.22 % H/dec	C <sub>DYN</sub> <sup>(4)</sup> 20 MN/m <sup>3</sup>

<sup>(1)</sup>ISO 845 - <sup>(2)</sup>ISO 37 - <sup>(3)</sup>ISO 8013, at 0.02 MPa - <sup>(4)</sup>EN 29052-1

### THERMAL PROPERTIES

TEMPERATURE RANGE -30°C / 70°C	REACTION TO FIRE Class E <sup>(1)</sup> / Class B2 <sup>(2)</sup>	THERMAL CONDUCTIVITY 0.13 W/m°C <sup>(3)</sup>	THERMAL RESISTANCE 0.064 m <sup>2</sup> C/W <sup>(3)</sup>
-----------------------------------	--	---	---

<sup>(1)</sup>EN 13501-1 - <sup>(2)</sup>DIN 4102 - <sup>(3)</sup>EN 12667

**ACOUSTICAL RESULTS**

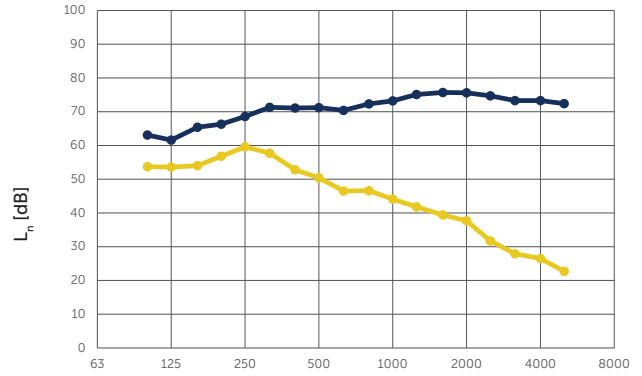
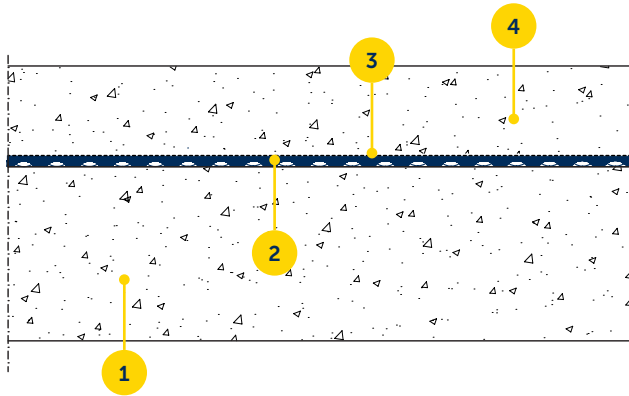

f [Hz]

—  $L_{n,0}$     —  $L_n$

**$\Delta L_w = 27 \text{ dB}^*$**

**Test setup + test values**

1. Standard reinforced concrete floor (140 mm)
2. CDM-MTA-8/4
3. PE-foil (0.2 mm)
4. Floating floor: reinforced concrete slab (100 mm)

\* Laboratory report available upon request

**PHYSICAL & MECHANICAL PROPERTIES**

